

AIRFIELD NAME	November 23	TIREE		EGPU	Scotland	
CALLSIGN (RADIO)	Tiree Information			122.705		
CALLSIGN (ES)	EGPU_I_TWR			Elev. 38ft		
LOCATION	N056.29.57.000		W006.52.09.000		VFR Conspicuity 7000	
LOCATION GEO.	2.5nm NNE Balemartine; Island of Tiree				QFE= QNH	
CHART SOURCE	NATS	RWY 05/23 Runway is not available for taxiing, take-off or landing to aircraft with MTWA in excess of 13,000 KG with the exception of SAAB 340 and Dornier 328. ALL Flights IN or OUT are PPR. A time slot may be advised.				
METAR AIRPORT	EGPF 129.575					
NAV AIDS	VOR 117.700MHz		Windsurfing and kite surfing may take place on beaches near the aerodrome. AFISO will advise. Paramotor activity by non-radio aircraft takes place occasionally throughout the year on the Isle of Tiree.			
RUNWAY	Headings	Dimension				Surface
	05 / 23	1481M x 30M				Grooved Asphalt
	11 / 29	799M x 19M	Asphalt			
AIRSPACE	CLASS Sfc > FL195	Transition level A3000ft				
CIRCUITS	All Circuits Left Hand at A1000. Helicopters in/out at A800ft. see below.					
NO FLY	No Noise Abatement, but avoid overflying local habitation below circuit height.					
LOCAL HAZARDS	Large flocks of GEESE over winter and 'stopover' during migration:- Autumn; Spring. Other sea-birds near cliffs. ALL Grass areas unsuitable for ALL Aircraft.					
HELICOPTER OPERATIONS	TLOF HELIPAD: 562954.43N 0065240.29W, 186.5 FT. Wheeled Helios use Runway, Skid Helios Direct to / from Helipad. EXCEPT Public service Helios, all helio operations are unlicensed.					
SPECIAL RULES	Runways LEFT hand: Right hand departure/arrivals, request and listen to traffic information. Back-tracking of Aircraft likely on all runways. Listen to AFISO and taxi with care.					

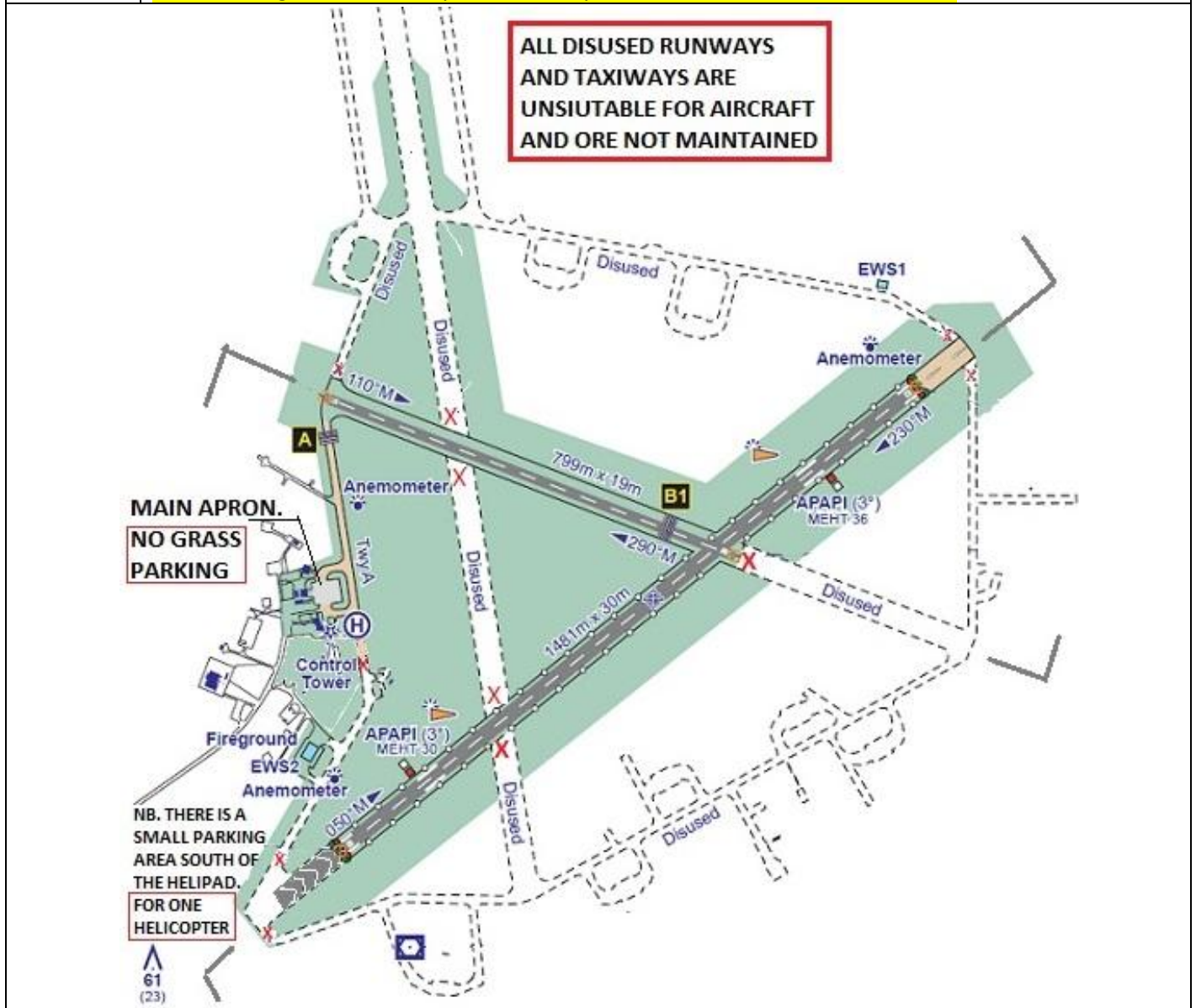

ALL OTHER RUNWAYS AND TAXIWAYS ARE DISUSED.

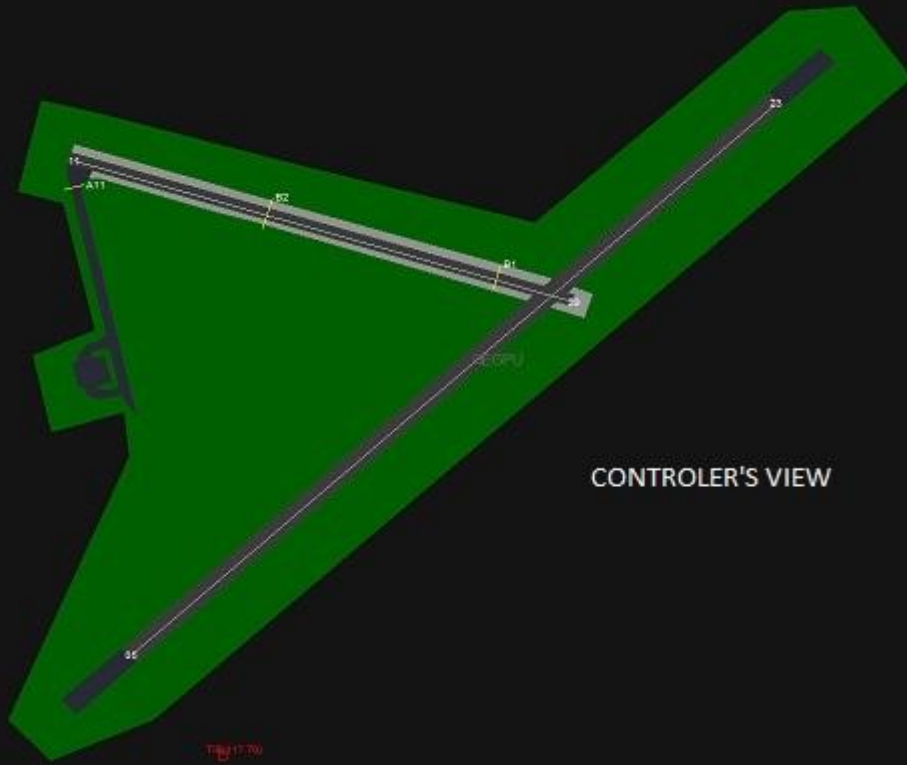

CONTROLLER'S VIEW



PLEASE PUT YOUR A/C CALLSIGN AFTER YOUR NAME. **NOT TO BE USED FOR REAL WORLD OPERATIONS**