

AIRFIELD NAME AND ICAO		May 24	SANDTOFT		EGCF	North
CALLSIGN (A/C RADIO)		Sandtoft Radio			130.415	
CALLSIGN (ES/VATSIM)		EGCF_R_TWR			Elev.13 ft	
LOCATION		Lat N053.33.35.000	Long W000.51.30.000		Conspicuity 7010 (circuits)	
LOCATION GEOGRAPHIC		7nm SW of Scunthorpe			QFE= QNH	
CHART SOURCE	NATS	Mandatory Overhead Joins at 2000ft QFE. NOTE areas to be avoided, shown on the chart below. This makes the circuit specific and tight.				
METAR AIRPORT	EGNJ 124.130	NORDO A/C ONLY PPR BEFORE departure. Caution Windfarms to the North				
NAV AIDS (FSX / PLANG3)	NONE	Circuit height is A1100ft [1000ft QFE]. ALL CIRCUITS to the NW.				
RUNWAY	Headings	Dimension	Surface	Asphalt		
	05 / 23	880m x 18m; 23 starter=170m; = Runway 710m		WATCH YOUR HEIGHT		
AIRSPACE	CLASS G	Transition level 5000ft		Airspace above is Class A Base A8500 Airway Y70		
CIRCUITS	1000ft QFE	All circuits north and west. 05 LH, 23 RH. Helicopters and Microlights 700ft QFE				
NO FLY AREAS	Do not overfly BELTON, 2nm East on the A161. Avoid all other villages below circuit height					
LOCAL HAZARDS	Birds; Ground Vehicle traffic; Training A/C in the circuit.					
HELICOPTERS	CAUTION multiple windfarms within 5nm, up to 650ft AGL. Not above 700ft QFE within the ATZ Helicopters operate as FIXED WING at 700ft. CAUTION Windfarms within 5nm of A/F					
REMARKS	A/C requiring BACKTRACK. May use the 'dispersal' taxiways (B & C) in order to give way to LANDING A/C. Ensure you announce your intentions when advised of landing traffic. When clear of runway and when re-commencing (continuing) Backtracking.					

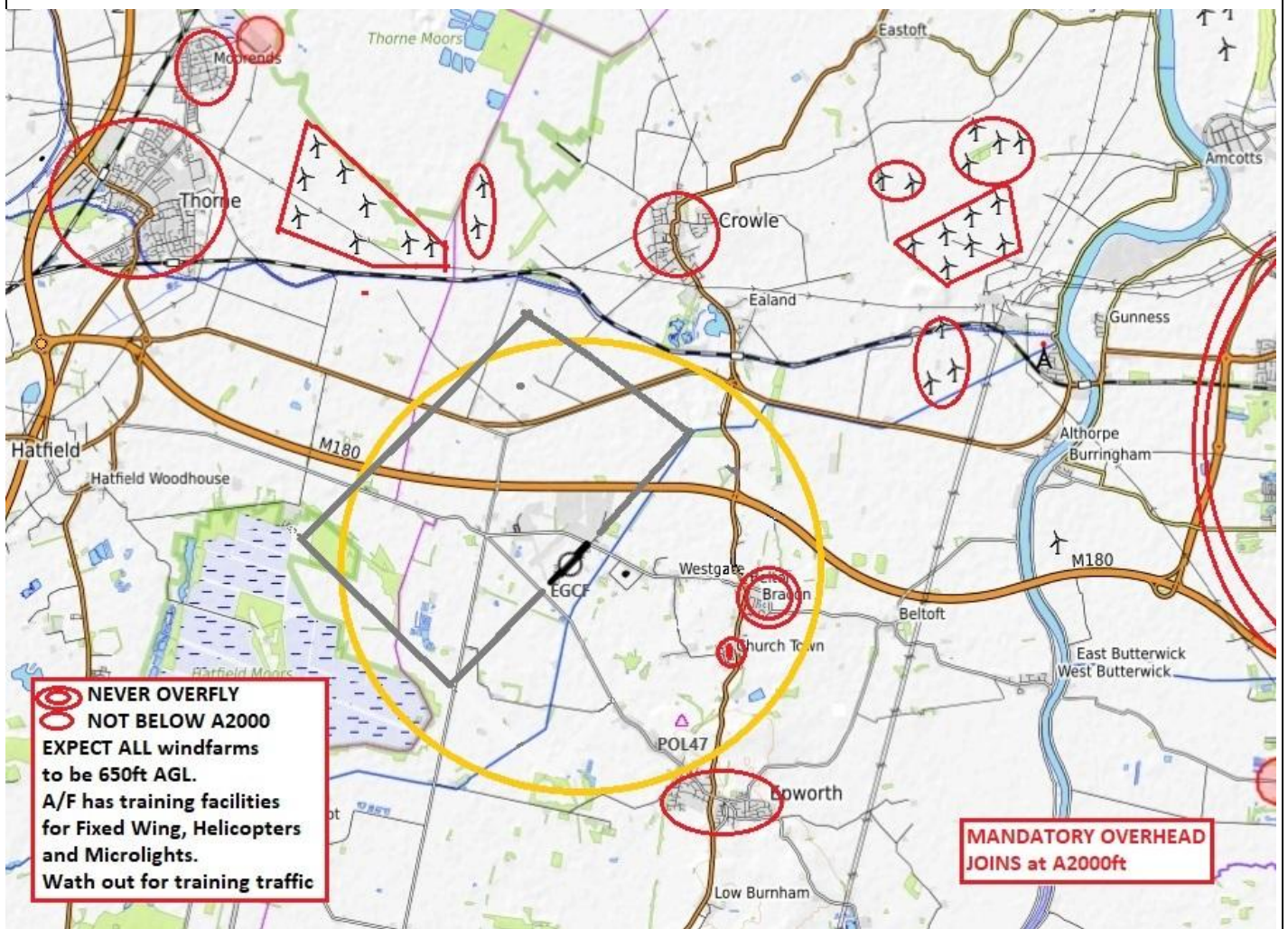

ONLY GRASS AREAS SHOWN AS GRASS PARKING ARE SUITABLE FOR A/C.

THE OLD DISPERSAL APRONS (B & C) ARE NOT AVAILABLE TO VISITING A/C, UNLES ADVISED BY ATC.

ALL OTHER TAXIWAYS AND APRONS ARE DISSUED FOR ALL A/C

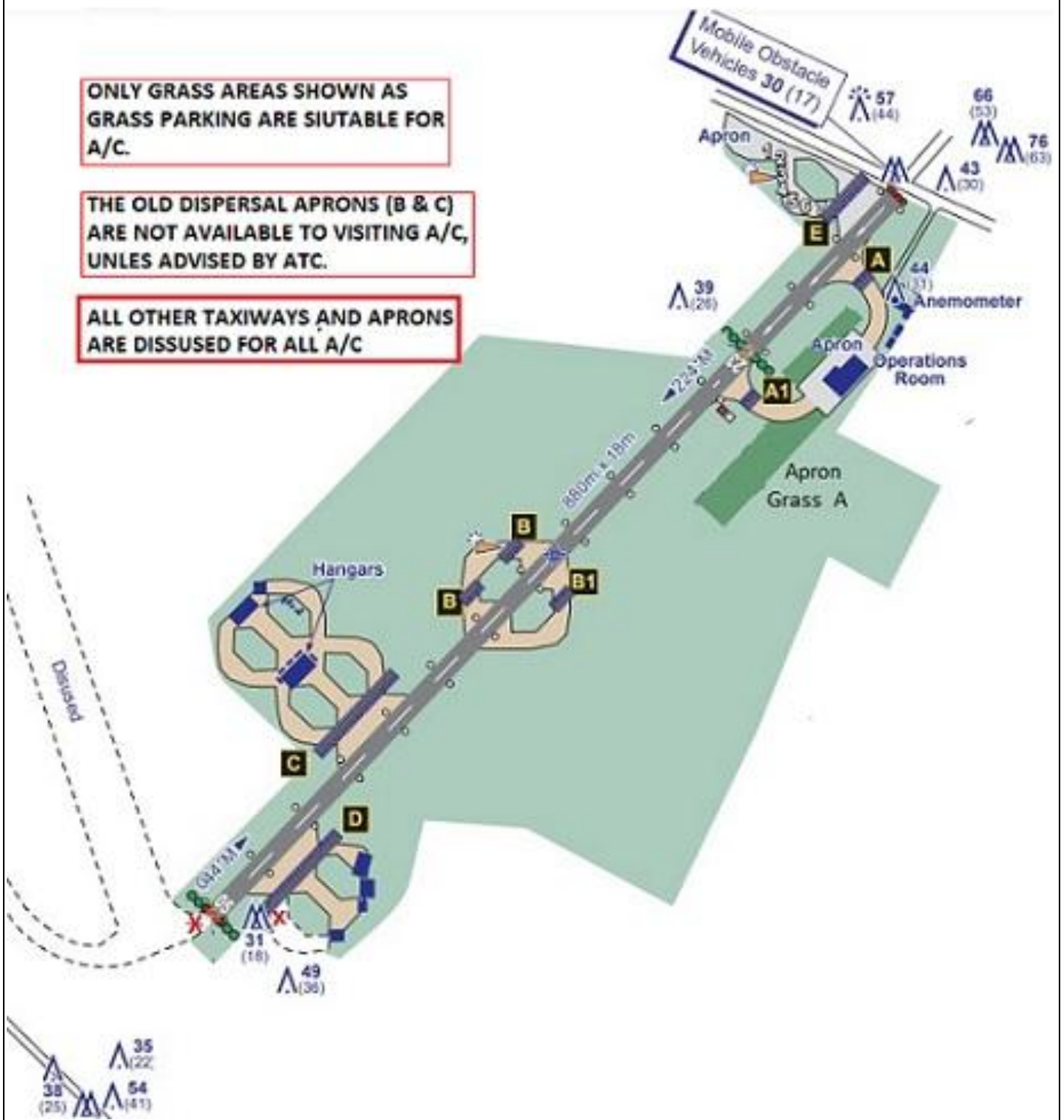

PILOTS: PLEASE PUT YOUR A/C CALLSIGN AFTER YOUR NAME.

NOT TO BE USED FOR REAL WORLD OPERATIONS