

AIRFIELD NAME & ICAO		November 23		<b>BIRMINGHAM</b>		<b>EGBB</b>	<b>Central</b>
CALLSIGN (A/C RADIO)		Birmingham Tower				118.305	
CALLSIGN (ES/VATSIM)		EGBB_TWR				Ground. 121.805	
LOCATION		Lat N052.27.14.000		Long W001.44.53.000		Elev.339 ft	
LOCATION GEOGRAPHIC		5.5nm ESE of Birmingham				VFR Conspicuity	
CHART SOURCE/VOR		NATS Director 131.005		Delivery 121.930		App. 118.050	
METAR AIRPORT		EGBB 136.030		RADAR 123.980		QFE= QNH -11HPscls	
NAV AIDS (FSX / PLANG3)		NDB BHX 406KHz		VOR. HON. 113.65. 6.5nmSE,0.5nm S of C/L		ILS 110.10MHz	
RUNWAYS	Headings	Dimension		Surface	Noise Abatement and Notes		
	15 / 33	3052m x 45m		Grooved Asphalt			
AIRSPACE	CLASS D CTR	Transition level 6000ft		Airspace above is:- A4500, Daventry CTA			
CIRCUITS HEIGHT / DIR.	Circuit direction as instructed by ATC. <b>NOT BELOW 2500ft QNH/2175ft QFE. On DOWNWIND LEG, UNTIL opposite the RUNWAY</b> , then make a smooth, low power descent. Unless instructed otherwise. GA A/C must turn final <b>NOT BELOW 1000ft QFE.</b>						
NO FLY AREA							
LOCAL HAZARDS	Cross winds and building turbulence may be encountered on the runway. Pigeons may cross runway up to 100ft AGL. Pyrotechnic bird dispersal will be used.						
HELICOPTER OPERATIONS	Helicopters will arrive onto / depart from the <b>main runway as instructed by ATC.</b> <b>Wheeled helicopters will ground taxi, using taxiways, at all times.</b> Other helicopters will <b>air taxi as instructed.</b>						
SPECIAL RULES	When vacating at 'C'. <b>DO NOT pass 'C2'</b> without ATC authority. <b>NO NORDO A/C ; GA propeller A/C NOT (RW)accepted between April and October.</b>						
REMARKS	<p>Runway 33 is the preferred runway up to a tail wind of 5kts. A/C requiring runway 15 may request it.</p> <p><b>DEPARTURES.</b></p> <p><b>Runway 15.</b> Climb straight ahead to <b>500ft QFE</b> (850ft QNH) <b>AND 1.5nm DME</b> (or 4.5nm HON). <b>THEN Easterly, LEFT turn LESS than or GREATER than 60°</b>, or as instructed. <b>Westerly, RIGHT Turn</b>, or as instructed by ATC.</p> <p><b>Runway 33.</b> Left or right turn, or as instructed by ATC</p> <p>Don't forget. If instructed <b>Left/Right TURNOUT</b>, you make your <b>heading 90° to the runway heading</b></p> <p>VRPs</p> <p>Frankley Reservoirs N052.25.13 W001.59.55    Lichfield Junction N052.41.10 W001.47.55</p> <p>Bedworth M6 Jnc3 N052.27.45 W001.29.39    M6 Hilton Pk. Services N052.38.38 W002.03.23</p> <p>Warwick M40 Jnc15 N052.15.37 W001.36.48    M40/M42 Interchange. N052.20.55 W001.48.35</p> <p>Tamworth M42 Jnc10 N052.36.12 W001.38.33    Studley N052.16.04 W001.53.53</p> <p>A/C operating in the vicinity of Birmingham CTA/CTR, CLEAR of COVENTRY and WEST of EAST MIDLANDS CTA may select squawk 0010. <b>LISTEN</b> on Birmingham approach 118.050.</p> <p><b>DO NOT talk to APPROACH UNLESS called first or you are in conflict with another A/C controlled by EGBB</b></p>						

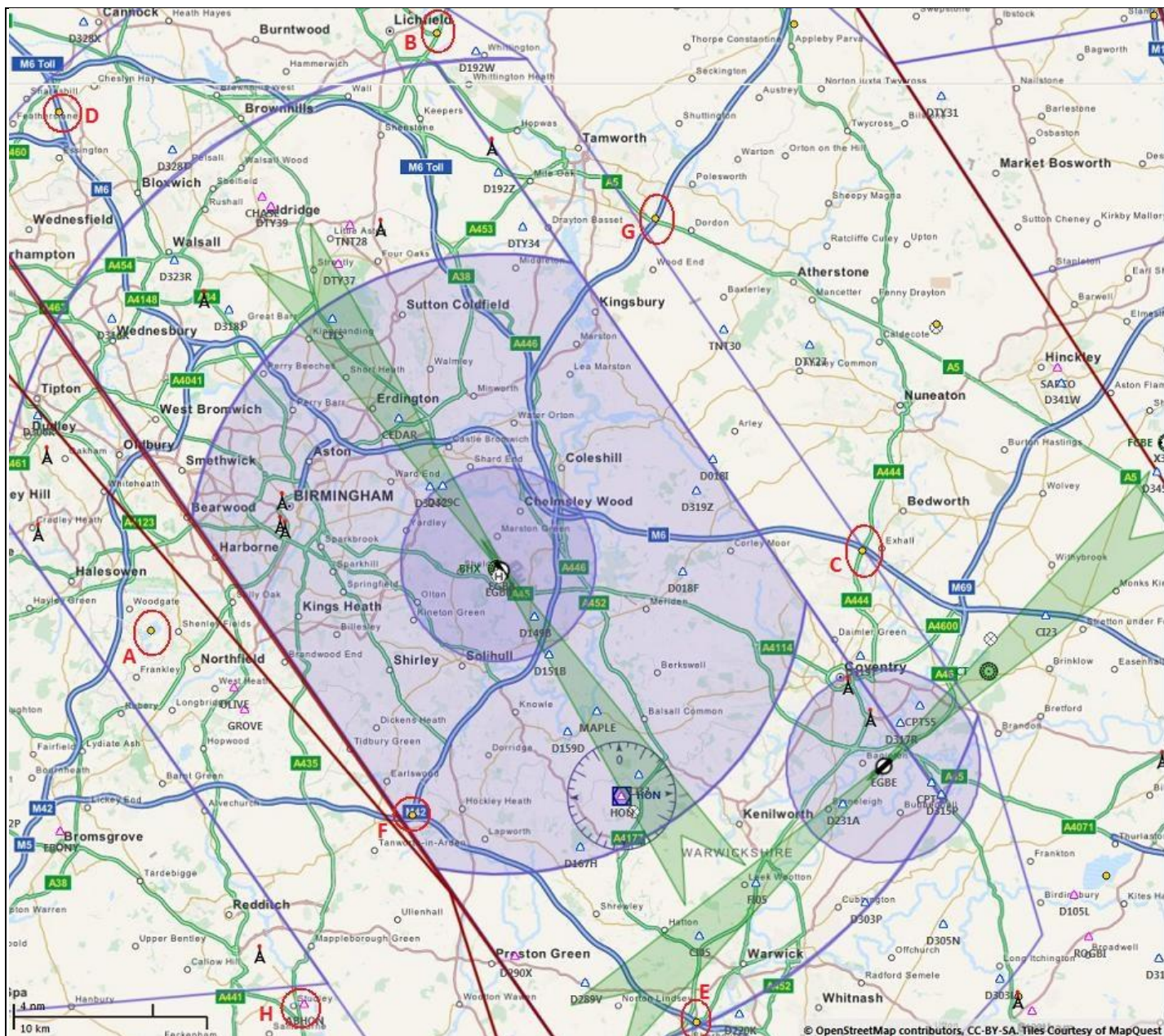

VRPs : lat/long are for planG coordinates

**A:** Frankley Reservoirs N052.420277 W001.9986111

**B:** Lichfield Junction N052.6861111 W001.7986111

**C:** Bedworth M6 Jnc3 N052.4625 W001.4941666

**D:** M6 Hilton Pk. Services N052.6438888 W002.0563888

**E:** Warwick M40 Jnc15 N052.2602777 W001.6133333

**F:** M40/M42 Interchange. N052.3486111 W001.8097222

**G:** Tamworth M42 Jnc10 N052.6033333 W001.6425000

**H:** Studley N052.2677777 W001.8980555

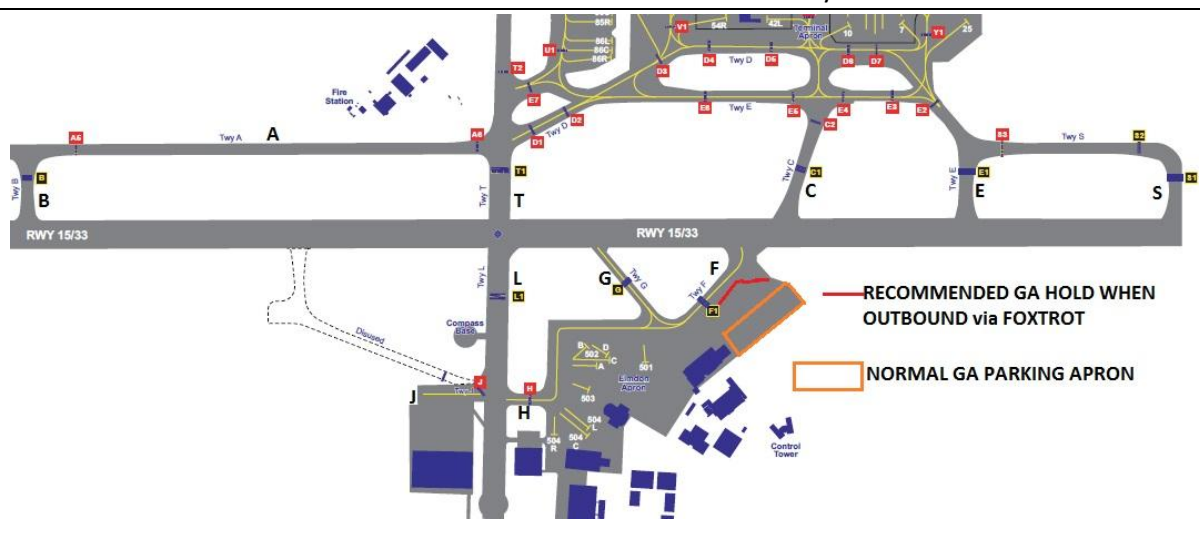

**ALL PILOTS: PLEASE PUT YOUR A/C CALLSIGN AFTER YOUR NAME.**

**NOT TO BE USED FOR REAL WORLD OPERATIONS**

— RECOMMENDED GA HOLD WHEN OUTBOUND via FOXTROT

◻ NORMAL GA PARKING APRON