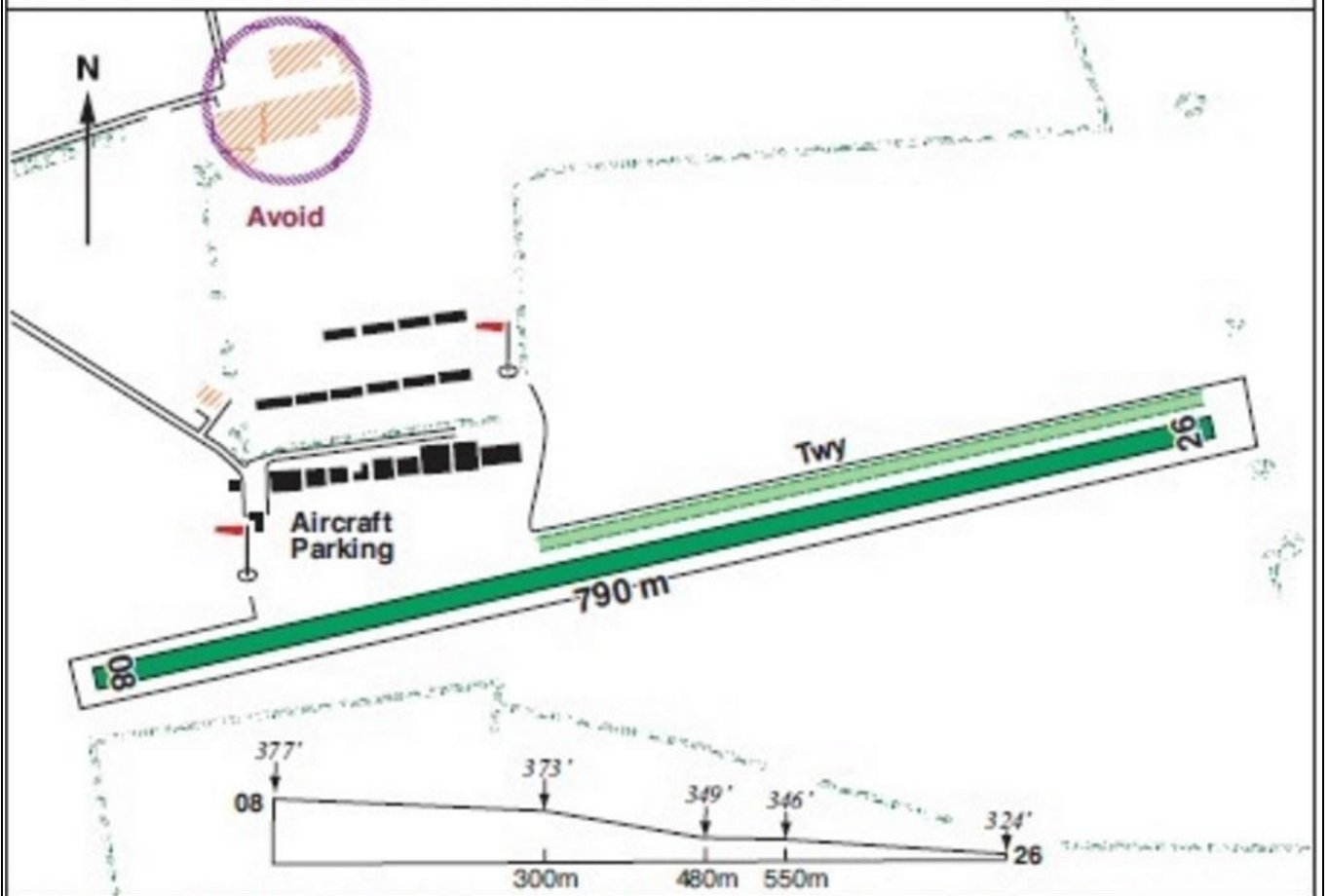

QNH**QFE****WIND****/**

AIRFIELD NAME AND ICAO	Fishburn		EG3D or X5FB
CALLSIGN (A/C RADIO)	Fishburn Radio		118.270
CALLSIGN (ES/VATSIM)	EG3D_R_TWR		Ground. ----
LOCATION	Lat N054.41.30.000	Long W001.27.85.000	Elev. 377ft
LOCATION GEOGRAPHIC	2.3nm NNW of Sedgfield; 2.5nm N of Sedgfield Racecourse		
CHART SOURCE	A/F website Unlicensed Airstrip		App.(Durham) 118.850
METAR AIRPORT	EGNV 119.800		QFE= QNH(METAR) - 12HPscIs
NAV AIDS (FSX / PLANG3)	NDB/	kHz	DME/ MHz
RUNWAYS	Headings	Dimension	Surface & notes
	08 / 26	790m x 30m	Grass (Undulating)
AIRSPACE/TRANS ALT QNH	CLASS	Transition level ft	Airspace above is Class Base Alt
CIRCUITS HEIGHT / DIR.	800ft QFE 1100ft QNH	Circuit to the NORTH; 08 LH; 26 RH.	
NO FLY AREAS	Avoid local villages; Trimdon; Fishburn and Bruce Middleham and noise sensitive area on chart.		
LOCAL HAZARDS	BIRDS. National Grid power lines 0.7nm from 26 threshold		
HELICOPTER OPERATIONS	STRICLY as for FIXED WING. DO NOT overfly area shown on chart, 300m N of A/F		
SPECIAL RULES	Join circuit ONLY FROM THE NORTH; NO OHJs. NO FLIGHT DEADSIDE Airfield is 3nm from NNW CTR/CTA of Durham Tees Valley (EGNV). ALL A/C contact Durham Approach (EGNV_APP) on 118.850 NOTE RUNWAY profile on chart. - 08 threshold-377ft; 26 threshold 324ft		

ALL PILOTS: PLEASE PUT YOUR A/C CALLSIGN AFTER YOUR NAME.**c/s Fishburn Radio 118-270. Durham APP 118-850.**

QNH

QFE

WIND

/

